



DEHNventil®modular DV M TT 255 (FM)

- DE Einbauanleitung
- GB Installation instructions
- IT Istruzioni di montaggio
- FR Instructions de montage
- NL Montagehandleiding
- ES Instrucciones de montaje
- PT Instruções de montagem
- DK Monteringsvejledning
- SE Monteringsanvisning
- FI Asennusohje
- GR Οδηγίες συναρμολόγησης
- PL Instrukcja montażu
- CZ Návod k montáži
- TR Montaj kılavuzu
- RU Инструкция по монтажу
- CN 安装说明
- HU Szerelési útmutató
- JP 設置説明書



I+II IEC 61643-11...  
1+2 EN 61643-11...

Pozidriv®Z2 (7 Nm)

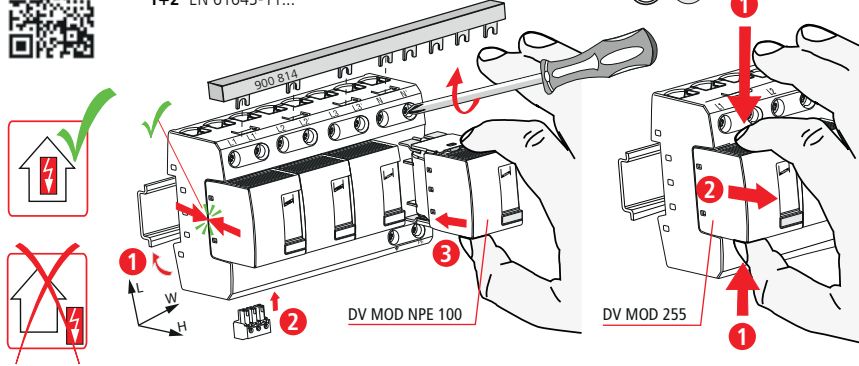

	DV M TT 255 (FM)	
	L-N	N-PE
	DV MOD 255	DV MOD NPE 50
$U_N$	230 / 400 V (50/60 Hz)	Tol.: 0V ... $U_C$
$U_C$	264 V (50/60 Hz)	255 V (50/60 Hz)
$I_n$ 1)	50 kA <sub>rms</sub>	100 A <sub>rms</sub>
$I_{SCCR}$	50 kA <sub>rms</sub>	100 A <sub>rms</sub>
$I_{imp}$ 10/350 µs	25 kA (L⇒N); 100 kA (N⇒PE); 100 kA (L1+L2+L3+N⇒PE)	
max. $I_{sc}$ 2)	125 A gG	
max. $I_{sc}$ 3)	315 A gG	
$\theta$	-40°C ... + 80°C (... +60°C 2))	
$I_{PE}$	<< 10 µA	
$\Phi$ 4)	5% ... 95%	
IP 5)	20	
L x W x H	90 mm x 144 mm x 73 mm	

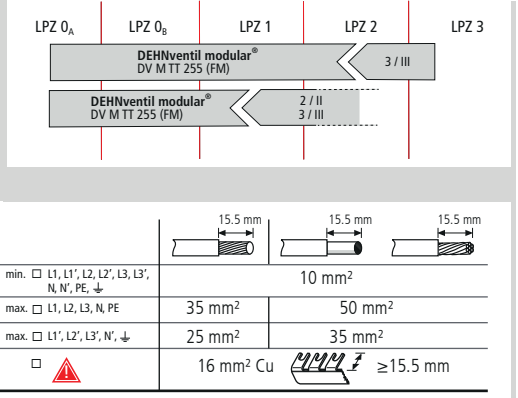

	15.5 mm	15.5 mm	15.5 mm
min. $\square$ L1', L2', L3', N, N', PE, ↓	10 mm <sup>2</sup>		
max. $\square$ L1, L2, L3, N, PE	35 mm <sup>2</sup>	50 mm <sup>2</sup>	
max. $\square$ L1', L2', L3', N', ↓	25 mm <sup>2</sup>	35 mm <sup>2</sup>	
$\square$ ⚠	16 mm <sup>2</sup> Cu $\geq 15.5$ mm		

2) TT, TN-S (3+1)

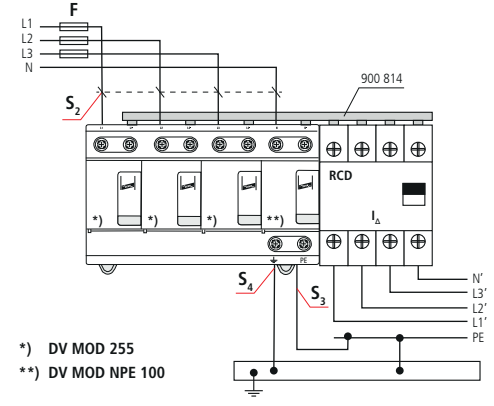
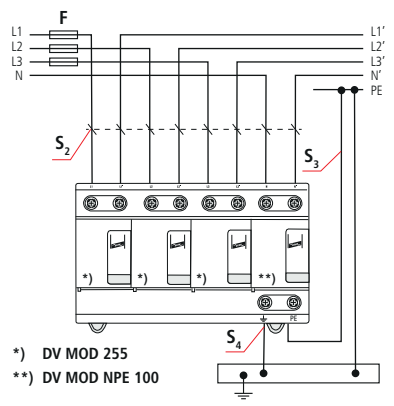

DEHNventil modular DV M TT 255 (FM)		F A gG	$S_2$ / mm <sup>2</sup>	$S_3$ / mm <sup>2</sup>	$S_4$ / mm <sup>2</sup>
F	$F \leq 125$ A gG	25	10	16	16
	$F > 125$ A gG	35	10	16	16
		40	10	16	16
		50	10	16	16
		63	10	16	16
		80	16	16	16
		100	25	16	16
		125	35	16	16

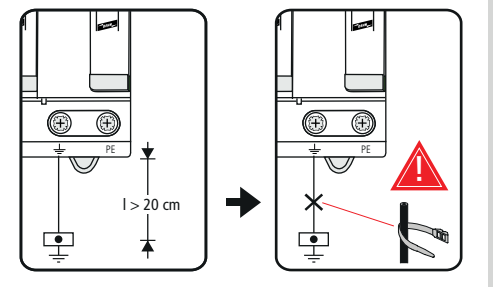

3) TT, TN-S (3+1)

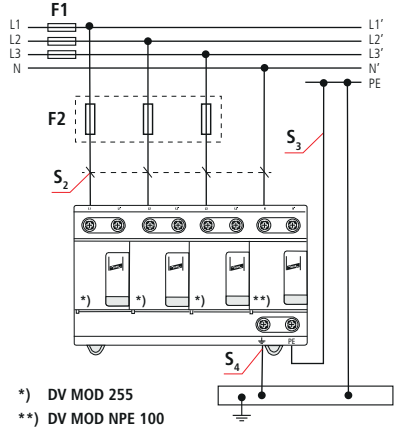

DEHNventil modular DV M TT 255 (FM)		F1 A gG	$S_2$ / mm <sup>2</sup>	$S_3$ / mm <sup>2</sup>	$S_4$ / mm <sup>2</sup>	F2 A gG
F1	$F1 > 315$ A gG	25	10	16	16	---
	$F2 \leq 315$ A gG	35	10	16	16	---
		40	10	16	16	---
		50	10	16	16	---
		63	10	16	16	---
		80	10	16	16	---
		100	16	16	16	---
		125	16	16	16	---
		160	25	25	25	---
		200	35	35	25	---
		250	35	35	25	---
		315	50	50	25	---
		>315	50	50	25	315

$I_k \leq 100$  kA<sub>rms</sub>

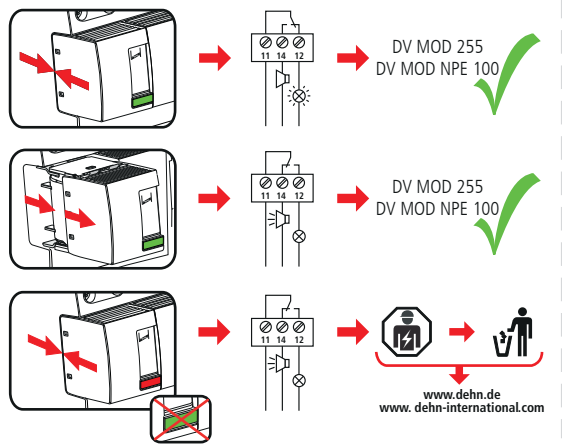

DEHNventil modular DV M TT 255 FM	
$U_N / I_N$	AC: 250 V / 0.5 A
	DC: 250 V / 0.1 A 125 V / 0.2 A 75 V / 0.5 A
max. 1.5 mm <sup>2</sup>	

